

Multi Tasking Non Technical Staff and Havaladar CBIC and CBN Examination 2024

Roll Number	
Candidate Name	
Venue Name	TCS Gito Bitan
Exam Date	14/11/2024
Exam Time	4:00 PM - 5:30 PM
Subject	MTS Non Tech Havaladar CBIC and CBN Examination 2024

Section : Numerical and Mathematical Ability

Q.1 The total surface area of a solid hemisphere is  $1848\text{ cm}^2$  then its volume (in  $\text{cm}^3$ ) is:

(use  $\pi = \frac{22}{7}$ )

- Ans
- ☐ 1.  $6473\frac{1}{3}$
- ☒ 2.  $5749\frac{1}{3}$
- ☐ 3.  $3370\frac{1}{3}$
- ☐ 4.  $2640\frac{2}{3}$

Question Type : MCQ

Question ID : 630680388852

Option 1 ID : 6306801515870

Option 2 ID : 6306801515872

Option 3 ID : 6306801515873

Option 4 ID : 6306801515871

Status : Answered

Chosen Option : 2

Q.2 The bar graph below shows the number of bicycles produced by a company from 1996 to 2000.

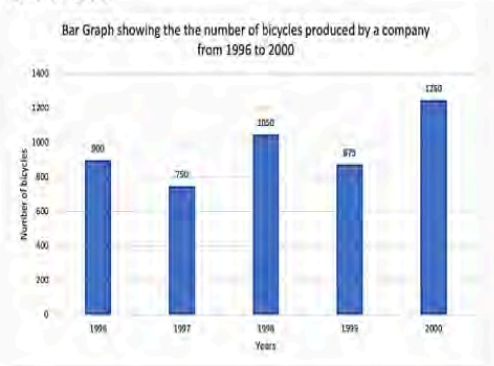

The combined number of bicycles produced between 1998 and 2000 is what percentage (rounded off to one decimal place) of the combined number of bicycles produced in 1996, 1997 and 1999?

- Ans
- ☐ 1. 88.9%
- ☒ 2. 91.1%
- ☐ 3. 93.6%
- ☐ 4. 90.3%

Question Type : MCQ

Question ID : 630680523719

Option 1 ID : 6306802047028

Option 2 ID : 6306802047027

Option 3 ID : 6306802047029

Option 4 ID : 6306802047030

Status : Answered

Chosen Option : 3



Download SSC CGL, CHSL E-BOOKS

[CLICK HERE](#)

Q.3 If the numerator of a fraction is increased by 12% and its denominator is diminished by 8%, then the value of the fraction is  $\frac{36}{69}$ . Find the original fraction.

- Ans
- ☐ 1.  $\frac{3}{4}$
  - ☐ 2.  $\frac{3}{2}$
  - ☐ 3.  $\frac{4}{3}$
  - ☒ 4.  $\frac{2}{3}$

Question Type : MCQ  
Question ID : 630680481178  
Option 1 ID : 6306801879283  
Option 2 ID : 6306801879281  
Option 3 ID : 6306801879282  
Option 4 ID : 6306801879280  
Status : Answered  
Chosen Option : 4

Q.4 Two trains of lengths 110 m and 100 m are running towards each other on parallel lines at the speed of 50 km/h and 58 km/h, respectively. How long will they take to cross each other after they meet?

- Ans
- ☒ 1. 7 seconds
  - ☐ 2. 5 seconds
  - ☐ 3. 4 seconds
  - ☐ 4. 6 seconds

Question Type : MCQ  
Question ID : 630680125166  
Option 1 ID : 630680485445  
Option 2 ID : 630680485443  
Option 3 ID : 630680485442  
Option 4 ID : 630680485444  
Status : Answered  
Chosen Option : 1

Q.5 Which of the following equations is correct?

- Ans
- ☒ 1.  $SP = (100 - \text{loss}\%) \times \frac{CP}{100}$
  - ☐ 2.  $\text{Loss} = SP - CP$
  - ☐ 3.  $\text{Gain \%} = CP / (\text{gain} \times 100)$
  - ☐ 4.  $SP = (100 - \text{gain}\%) \times \frac{CP}{100}$

Question Type : MCQ  
Question ID : 630680106882  
Option 1 ID : 630680415102  
Option 2 ID : 630680415100  
Option 3 ID : 630680415101  
Option 4 ID : 630680415103  
Status : Answered  
Chosen Option : 1

Q.6 What is the HCF of 513, 1134 and 1215?

- Ans
- ☐ 1. 3
  - ☒ 2. 27
  - ☐ 3. 81
  - ☐ 4. 19

Question Type : MCQ  
Question ID : 630680103081  
Option 1 ID : 630680400586  
Option 2 ID : 630680400583  
Option 3 ID : 630680400584  
Option 4 ID : 630680400585  
Status : Answered  
Chosen Option : 2

Q.7 If a semi-circular plot has radius 100 m, find its perimeter. (Use  $\pi = 3.14$ )

- Ans ☒ 1. 414 m  
☒ 2. 514 m  
☒ 3. 828 m  
☒ 4. 500 m

Question Type : MCQ  
Question ID : 630680109014  
Option 1 ID : 630680422920  
Option 2 ID : 630680422922  
Option 3 ID : 630680422923  
Option 4 ID : 630680422921  
Status : Answered  
Chosen Option : 2

Q.8 A train increases its regular speed by 12.5% and reaches its destination 20 minutes earlier. What is the actual time taken by the train on the journey?

- Ans ☒ 1. 150 min  
☒ 2. 180 min  
☒ 3. 120 min  
☒ 4. 110 min

Question Type : MCQ  
Question ID : 630680288004  
Option 1 ID : 6306801119925  
Option 2 ID : 6306801119926  
Option 3 ID : 6306801119924  
Option 4 ID : 6306801119923  
Status : Answered  
Chosen Option : 2

Q.9 A shop has two promotional offers: buy three shirts, get one shirt free, or a 25% discount on the marked price. If a customer buys five using both offers, what discount will he get all together?

- Ans ☒ 1. 30%  
☒ 2. 50%  
☒ 3. 27.5%  
☒ 4. 25%

Question Type : MCQ  
Question ID : 630680623808  
Option 1 ID : 6306802441385  
Option 2 ID : 6306802441382  
Option 3 ID : 6306802441384  
Option 4 ID : 6306802441383  
Status : Answered  
Chosen Option : 1

Q.10 The quantity of milk ordered on the first, second, third and fourth day of a four day ceremony is in the proportion of 30 litres, 24 litres, 35 litres and 'x' litres, respectively. Find the quantity of milk (in litres) ordered on the fourth day.

- Ans ☒ 1. 26  
☒ 2. 32  
☒ 3. 30  
☒ 4. 28

Question Type : MCQ  
Question ID : 630680470322  
Option 1 ID : 6306801837044  
Option 2 ID : 6306801837046  
Option 3 ID : 6306801837043  
Option 4 ID : 6306801837045  
Status : Answered  
Chosen Option : 4

Q.11 A dealer sells his goods at 5% loss on cost price but uses  $12\frac{1}{2}\%$  less weight. Find his percentage of loss or gain.

- Ans
- ✓ 1. Gain  $8\frac{4}{7}\%$
  - ✗ 2. Gain  $7\frac{4}{7}\%$
  - ✗ 3. Loss  $7\frac{8}{7}\%$
  - ✗ 4. Loss  $8\frac{4}{7}\%$

Question Type : MCQ  
Question ID : 630680388592  
Option 1 ID : 6306801514831  
Option 2 ID : 6306801514833  
Option 3 ID : 6306801514830  
Option 4 ID : 6306801514832  
Status : Answered  
Chosen Option : 1

Q.12 A school's 41 students weigh an average of 52 kg. The mean weight increases by 500 grams when the teacher's weight is taken into account.

- Ans
- ✓ 1. 73 kg
  - ✗ 2. 72 kg
  - ✗ 3. 74 kg
  - ✗ 4. 71 kg

Q.13 Study the given table and answer the question that follows.  
The table shows the number of candidates who appeared (both male and female) in a Public Examination and the percentage of those who qualified in the examination from two states M and N. A few values are missing in the table (indicated by -----). You will be required to fill them up according to the question.

Year	State M		State N	
	Number of appeared candidates	Percentage of qualified candidates	Number of appeared candidates	Percentage of qualified candidates
2002	540	80	-----	60
2003	660	70	-----	65
2004	-----	90	850	70
2005	550	60	780	95
2006	980	-----	860	-----

If the total number of candidates appeared from State M is 3500 from 2002 to 2006, then what was the number of candidates who qualified from State M in 2004?

- Ans
- ✗ 1. 558
  - ✓ 2. 693
  - ✗ 3. 782
  - ✗ 4. 957

Question Type : MCQ  
Question ID : 630680523846  
Option 1 ID : 6306802047538  
Option 2 ID : 6306802047536  
Option 3 ID : 6306802047535  
Option 4 ID : 6306802047537  
Status : Answered  
Chosen Option : 2

Q.14 For a sum of ₹15,000 the rate of interest of 8.5% per annum simple interest, find the interest earned (in ₹) in 5 years 3 months.

- Ans
- ☐ 1. 21,375
  - ☐ 2. 21,693.75
  - ☐ 3. 6,375
  - ☒ 4. 6,693.75

Question Type : MCQ  
Question ID : 630680397947  
Option 1 ID : 6306801551805  
Option 2 ID : 6306801551802  
Option 3 ID : 6306801551804  
Option 4 ID : 6306801551803  
Status : Answered  
Chosen Option : 4

Q.15 The average weight of Rakesh and his five friends is 62 kg. If Rakesh is 6 kg heavier than the average weight of his five friends, then find the weight of Rakesh.

- Ans
- ☐ 1. 61 kg
  - ☐ 2. 62 kg
  - ☒ 3. 67 kg
  - ☐ 4. 68 kg

Question Type : MCQ  
Question ID : 630680484346  
Option 1 ID : 6306801891733  
Option 2 ID : 6306801891732  
Option 3 ID : 6306801891731  
Option 4 ID : 6306801891730  
Status : Answered  
Chosen Option : 4

Q.16 The average of two numbers is 13.5 and the square root of their product is  $6\sqrt{5}$ . Find the numbers.

- Ans
- ☐ 1. 11 and 16
  - ☒ 2. 12 and 15
  - ☐ 3. 10 and 17
  - ☐ 4. 13 and 14

Question Type : MCQ  
Question ID : 630680449435  
Option 1 ID : 6306801754866  
Option 2 ID : 6306801754868  
Option 3 ID : 6306801754865  
Option 4 ID : 6306801754867  
Status : Answered  
Chosen Option : 2

Q.17 A solid hemisphere of radius 12 cm is melted into N identical cones, each of radius 6 cm and height 8 cm. What is the value of N?

- Ans
- ☐ 1. 10
  - ☒ 2. 12
  - ☐ 3. 15
  - ☐ 4. 8

Question Type : MCQ  
Question ID : 630680526643  
Option 1 ID : 6306802058640  
Option 2 ID : 6306802058639  
Option 3 ID : 6306802058638  
Option 4 ID : 6306802058641  
Status : Answered  
Chosen Option : 2

Q.18 The average weight of a family of five members (in kg) whose weights are 40 kg, 49 kg, 56 kg, 68 kg and 38 kg is:

- Ans
- ☒ 1. 51.2
  - ☒ 2. 49.2
  - ☒ 3. 52.2
  - ☒ 4. 50.2

Question Type : MCQ  
Question ID : 630680551647  
Option 1 ID : 6306802156814  
Option 2 ID : 6306802156815  
Option 3 ID : 6306802156816  
Option 4 ID : 6306802156813  
Status : Answered  
Chosen Option : 4

Q.19 Find the simple interest (in ₹) on ₹3500 as a sum borrowed at 7% per year rate of interest for 4 years.

- Ans
- ☒ 1. 980
  - ☒ 2. 920
  - ☒ 3. 1020
  - ☒ 4. 940

Question Type : MCQ  
Question ID : 630680591980  
Option 1 ID : 6306802316387  
Option 2 ID : 6306802316389  
Option 3 ID : 6306802316388  
Option 4 ID : 6306802316390  
Status : Answered  
Chosen Option : 1

Q.20 What sum (in ₹) will earn a simple interest of ₹360 in 3 years at 12% per year rate of interest?

- Ans
- ☒ 1. 1500
  - ☒ 2. 500
  - ☒ 3. 2000
  - ☒ 4. 1000

Question Type : MCQ  
Question ID : 630680612188  
Option 1 ID : 6306802395487  
Option 2 ID : 6306802395485  
Option 3 ID : 6306802395486  
Option 4 ID : 6306802395484  
Status : Answered  
Chosen Option : 4

Section : Reasoning Ability and Problem Solving

Q.1 'RJ 17' is related to 'QL 19' in a certain way. In the same way, 'CP 12' is related to 'BR 14'. To which of the following is 'OJ 22' related following the same logic?

- Ans
- ☒ 1. QJ 22
  - ☒ 2. PK 23
  - ☒ 3. NL 24
  - ☒ 4. NK 21

Question Type : MCQ  
Question ID : 630680381038  
Option 1 ID : 6306801485130  
Option 2 ID : 6306801485127  
Option 3 ID : 6306801485128  
Option 4 ID : 6306801485129  
Status : Answered  
Chosen Option : 3

Q.2 What will come in the place of the question mark (?) in the following equation, if '+' and 'x' are interchanged and '-' and '÷' are interchanged?  
 $78 - 6 \div 6 + 2 \times 8 = ?$

- Ans ☒ 1. 7  
☒ 2. 9  
☒ 3. 4  
☒ 4. 0

Question Type : MCQ  
Question ID : 630680378048  
Option 1 ID : 6306801473253  
Option 2 ID : 6306801473254  
Option 3 ID : 6306801473252  
Option 4 ID : 6306801473251  
Status : Answered  
Chosen Option : 2

Q.3 A, B, C, D, E, F, G and H are sitting around a circular table facing out to the centre (but not necessarily in the same order). D is sitting to the immediate left of A and third to the right of H. B is sitting third to the right of F. F is the immediate neighbour of C and G. C is sitting third to the right of A. Who is sitting fourth to the right of A?

- Ans ☒ 1. B  
☒ 2. C  
☒ 3. D  
☒ 4. H

Question Type : MCQ  
Question ID : 630680379066  
Option 1 ID : 6306801477311  
Option 2 ID : 6306801477312  
Option 3 ID : 6306801477314  
Option 4 ID : 6306801477313  
Status : Answered  
Chosen Option : 4

Q.4 What will come in the place of the question mark (?) in the following equation, if '+' and '-' are interchanged and 'x' and '÷' are interchanged?

$24 \times 576 \div 72 - 108 + 91 = ?$

- Ans ☒ 1. 12  
☒ 2. 18  
☒ 3. 2  
☒ 4. 20

Question Type : MCQ  
Question ID : 630680272728  
Option 1 ID : 6306801059471  
Option 2 ID : 6306801059472  
Option 3 ID : 6306801059473  
Option 4 ID : 6306801059474  
Status : Answered  
Chosen Option : 4

Q.5 In a certain code language, 'GOES' is coded as '4268' and 'OILY' is coded as '3457'. What is the code for 'O' in the given code language?

- Ans ☒ 1. 3  
☒ 2. 4  
☒ 3. 2  
☒ 4. 5

Question Type : MCQ  
Question ID : 630680435782  
Option 1 ID : 6306801701043  
Option 2 ID : 6306801701041  
Option 3 ID : 6306801701042  
Option 4 ID : 6306801701044  
Status : Answered  
Chosen Option : 2

Q.6 In a certain code language, 'you read book' is written as 'hm rn op' and 'book is good' is written as 'cf am rn'. What is the code for 'book' in that language?

- Ans
- ☒ 1. op
  - ☒ 2. cf
  - ☒ 3. rn
  - ☒ 4. am

Question Type : MCQ  
Question ID : 630680379156  
Option 1 ID : 6306801477672  
Option 2 ID : 6306801477674  
Option 3 ID : 6306801477673  
Option 4 ID : 6306801477671  
Status : Answered  
Chosen Option : 3

Q.7 A, B, C, D, E, F and G are sitting around a circular table facing the centre (but not necessarily in the same order). B sits to the immediate left of E. C sits to the immediate left of F. F sits second to the left of G. D sits third to the left of E.

Who sits third to the left of A?

- Ans
- ☒ 1. G
  - ☒ 2. F
  - ☒ 3. B
  - ☒ 4. E

Question Type : MCQ  
Question ID : 630680815678  
Option 1 ID : 6306803196013  
Option 2 ID : 6306803196016  
Option 3 ID : 6306803196014  
Option 4 ID : 6306803196015  
Status : Answered  
Chosen Option : 1

Q.8 Read the given statements and conclusions carefully. Assuming that the information given in the statements is true, even if it appears to be at variance with commonly known facts, decide which of the given conclusions logically follow(s) from the statements.

Statements:  
All papayas are oranges.  
Some oranges are apples.

Conclusions:  
(I) At least some apples are oranges.  
(II) Some papayas are apples.

- Ans
- ☒ 1. Only conclusion I follows
  - ☒ 2. Only conclusion II follows
  - ☒ 3. Neither conclusion I nor II follows
  - ☒ 4. Both conclusion I and II follow

Question Type : MCQ  
Question ID : 630680410974  
Option 1 ID : 6306801602648  
Option 2 ID : 6306801602649  
Option 3 ID : 6306801602651  
Option 4 ID : 6306801602650  
Status : Answered  
Chosen Option : 1

Q.9 Select the figure from the options that can replace the question mark (?) and logically complete the series.

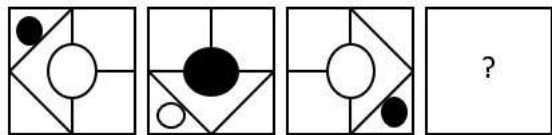

Ans

- ☒ 1.
- ☒ 2.
- ☒ 3.
- ☒ 4.

Question Type : MCQ  
Question ID : 630680279338  
Option 1 ID : 6306801085621  
Option 2 ID : 6306801085619  
Option 3 ID : 6306801085622  
Option 4 ID : 6306801085620  
Status : Answered  
Chosen Option : 3

**Q.10** A square sheet of paper is folded along the dotted line successively along the directions shown and is then punched in the last. How would the paper look when unfolded?



**Ans**

✓ 1.

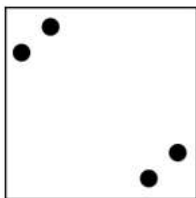

**2.**

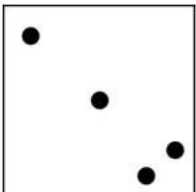

**3**

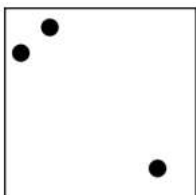

4.

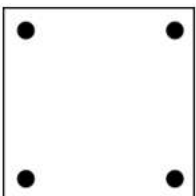

Question Type : MCQ

Question ID : 630680524416

Option 1 ID : 6306802049765

Option 2 ID : 6306802049766

Option 3 ID : 6306802049763

Option 4 ID : 6306802049764

Status : **Answered**

Chosen Option : 1

**Q.11** In the following number-pairs, the second number is obtained by applying certain mathematical operations to the first number. Select the set in which the numbers are related in the same way as are the numbers of the following sets.

(NOTE: Operations should be performed on the whole numbers, without breaking down the numbers into their constituent digits. E.g. 13 – Operations on 13 such as adding/ subtracting /multiplying to 13 can be performed. Breaking down 13 into 1 and 3 and then performing mathematical operations on 1 and 3 is not allowed.)

11, 99

**Ans**  1. 19, 131

 2. 21. 123

3. 15, 125

✓ 4. 17, 153

Question Type : MCQ

Question ID : 630680399140

Option 1 ID : 6306801556520

Option 2 ID : 6306801556521

Option 3 ID : 6306801556518

Option 4 ID : 6306801556519

Status : **Answered**

Chosen Option : 4

Q.12 Select the correct mirror image of the given figure when the mirror is placed at MN as shown below.

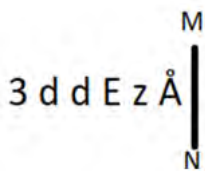

Ans

- ✓ 1. Å z E b b 3
- ✗ 2. Å z E p p 3
- ✗ 3. Å z E d d 3
- ✗ 4. Å z E b b 3

Question Type : MCQ

Question ID : 630680525313

Option 1 ID : 6306802053339

Option 2 ID : 6306802053337

Option 3 ID : 6306802053338

Option 4 ID : 6306802053336

Status : Answered

Chosen Option : 1

Q.13 In a certain code language, 'MONKEY' is coded as 'BHNQRP' and 'NAP' is coded as 'SDQ'. What is the code for 'JUTEBAG' in the given code language?

- ✗ 1. JDEH WXN
- ✗ 2. JDEH UXM
- ✗ 3. JDEK WXM
- ✓ 4. JDEH WXM

Question Type : MCQ

Question ID : 630680465159

Option 1 ID : 6306801816674

Option 2 ID : 6306801816673

Option 3 ID : 6306801816672

Option 4 ID : 6306801816671

Status : Answered

Chosen Option : 4

Q.14 In a certain code language, 'WORK' is written as '5964' and 'RISE' is coded as '1348'. How is 'R' coded in the given language?

- ✗ 1. 3
- ✗ 2. 8
- ✓ 3. 4
- ✗ 4. 1

Question Type : MCQ

Question ID : 630680439084

Option 1 ID : 6306801714150

Option 2 ID : 6306801714149

Option 3 ID : 6306801714151

Option 4 ID : 6306801714148

Status : Answered

Chosen Option : 3

Q.15 What should come in place of the question mark (?) in the given series based on the English alphabetical order?

XCW, UGS, RKO, ?, LSG

- Ans
- ☒ 1. OOM
  - ☐ 2. OOK
  - ☐ 3. OLO
  - ☐ 4. OMN

Question Type : MCQ  
Question ID : 630680815699  
Option 1 ID : 6306803196100  
Option 2 ID : 6306803196097  
Option 3 ID : 6306803196099  
Option 4 ID : 6306803196098  
Status : Answered  
Chosen Option : 2

Q.16 Read the given statements and conclusions carefully. Assuming that the information given in the statements is true, even if it appears to be at variance with commonly known facts, decide which of the given conclusions logically follow(s) from the statements.

Statements:

Some tomatoes are potatoes.

No potato is an onion.

Conclusions:

(I) Some potatoes are not tomatoes.

(II) No tomato is an onion.

- Ans
- ☐ 1. Both conclusions I and II follow
  - ☐ 2. Only conclusion I follows
  - ☐ 3. Only conclusion II follows
  - ☒ 4. Neither conclusion I nor II follows

Question Type : MCQ  
Question ID : 630680387625  
Option 1 ID : 6306801511168  
Option 2 ID : 6306801511166  
Option 3 ID : 6306801511167  
Option 4 ID : 6306801511169  
Status : Answered  
Chosen Option : 3

Q.17 CDFG is related to FGIJ in a certain way based on the English alphabetical order. In the same way, MNPQ is related to PQST. To which of the following is HIKL related, following the same logic?

- Ans
- ☒ 1. KLNO
  - ☐ 2. KLNP
  - ☐ 3. JKNO
  - ☐ 4. LKNO

Question Type : MCQ  
Question ID : 630680439730  
Option 1 ID : 6306801716680  
Option 2 ID : 6306801716678  
Option 3 ID : 6306801716679  
Option 4 ID : 6306801716681  
Status : Answered  
Chosen Option : 1

Q.18 Select the number from among the given options that can replace the question mark (?) in the following series.  
10, ?, 46, 94, 190, 382, 766

- Ans
- ☐ 1. 20
  - ☒ 2. 22
  - ☐ 3. 18
  - ☐ 4. 24

Question Type : MCQ  
Question ID : 630680429517  
Option 1 ID : 6306801676117  
Option 2 ID : 6306801676118  
Option 3 ID : 6306801676116  
Option 4 ID : 6306801676119  
Status : Answered  
Chosen Option : 2

Q.19 Select the figure from among the given options that can replace the question mark (?) in the following series and complete the pattern.

	5		U		0		5	
B	L	O	U	2	B	5	O	L
2			L		U		2	
								?

Ans

✖ 1.

			2
B	U	L	O
5			

✔ 2.

			B
2	U	L	O
5			

✖ 3.

			2
L	O	B	5
U			

✖ 4.

			5
B	L	O	U
2			

Question Type : MCQ

Question ID : 630680441074

Option 1 ID : 6306801721951

Option 2 ID : 6306801721953

Option 3 ID : 6306801721952

Option 4 ID : 6306801721950

Status : Answered

Chosen Option : 2

Q.20 3 is related to 40 following a certain logic. Following the same logic, 5 is related to 66. To which of the following is 10 related, following the same logic?

(NOTE : Operations should be performed on the whole numbers, without breaking down the numbers into its constituent digits. E.g. 13 – Operations on 13 such as adding / subtracting / multiplying, etc., to 13 can be performed. Breaking down 13 into 1 and 3 and then performing mathematical operations on 1 and 3 is not allowed.)

Ans ✔ 1. 131

✖ 2. 125

✖ 3. 129

✖ 4. 127

Question Type : MCQ

Question ID : 630680441693

Option 1 ID : 6306801724389

Option 2 ID : 6306801724386

Option 3 ID : 6306801724388

Option 4 ID : 6306801724387

Status : Answered

Chosen Option : 1

Section : General Awareness

Q.1 Limestone is composed of:

- Ans ☒ 1. aluminium oxide  
☒ 2. calcium carbonate  
☒ 3. iron oxide  
☒ 4. sodium carbonate

Question Type : MCQ  
Question ID : 630680456068  
Option 1 ID : 6306801781212  
Option 2 ID : 6306801781211  
Option 3 ID : 6306801781213  
Option 4 ID : 6306801781214  
Status : Answered  
Chosen Option : 2

Q.2 What is the term for the gradual, sequential changes in species composition in an ecosystem over time?

- Ans ☒ 1. Succession  
☒ 2. Extinction  
☒ 3. Evolution  
☒ 4. Adaptation

Question Type : MCQ  
Question ID : 630680412065  
Option 1 ID : 6306801607097  
Option 2 ID : 6306801607096  
Option 3 ID : 6306801607095  
Option 4 ID : 6306801607098  
Status : Answered  
Chosen Option : 3

Q.3 Which edition of 'Pradhan Mantri Kaushal Vikas Yojana' has been announced in union budget 2023?

- Ans ☒ 1. 4.0  
☒ 2. 5.0  
☒ 3. 3.0  
☒ 4. 2.0

Question Type : MCQ  
Question ID : 630680467056  
Option 1 ID : 6306801824179  
Option 2 ID : 6306801824180  
Option 3 ID : 6306801824178  
Option 4 ID : 6306801824177  
Status : Answered  
Chosen Option : 1

Q.4 Which of the following is NOT a drawback of the barter system?

- Ans ☒ 1. Difficulty in contractual payments  
☒ 2. Surplus goods are replaced with other goods  
☒ 3. Double coincidence of wants  
☒ 4. Lack of a common unit of value

Question Type : MCQ  
Question ID : 630680111952  
Option 1 ID : 630680433536  
Option 2 ID : 630680433537  
Option 3 ID : 630680433535  
Option 4 ID : 630680433534  
Status : Answered  
Chosen Option : 4



Q.5 As per Census 2011, what is the average female literacy rate in India?

- Ans ☒ 1. 82.45%  
☒ 2. 74.34%  
☒ 3. 65.46%  
☒ 4. 60.76%

Question Type : MCQ  
Question ID : 630680510912  
Option 1 ID : 6306801996779  
Option 2 ID : 6306801996778  
Option 3 ID : 6306801996781  
Option 4 ID : 6306801996780  
Status : Answered  
Chosen Option : 3

Q.6 Which brick-made minaret holds the record for being the world's tallest tower at 73 metres?

- Ans ☒ 1. Minaret of Turin (Italy)  
☒ 2. Minaret of Jam (Afghanistan)  
☒ 3. Qutb Minar (India)  
☒ 4. Kalyan Minaret (Uzbekistan)

Question Type : MCQ  
Question ID : 630680590668  
Option 1 ID : 6306802311158  
Option 2 ID : 6306802311155  
Option 3 ID : 6306802311157  
Option 4 ID : 6306802311156  
Status : Answered  
Chosen Option : 3

Q.7 Which state hosted the 6<sup>th</sup> edition of Khelo India Youth Games in 2024?

- Ans ☒ 1. Tamil Nadu  
☒ 2. Telangana  
☒ 3. Karnataka  
☒ 4. Kerala

Question Type : MCQ  
Question ID : 630680563505  
Option 1 ID : 6306802202976  
Option 2 ID : 6306802202973  
Option 3 ID : 6306802202974  
Option 4 ID : 6306802202975  
Status : Answered  
Chosen Option : 1

Q.8 The Aatmanirbhar Bharat Rojgar Yojana was implemented through which organisation?

- Ans ☒ 1. Employees Provident Fund Organisation  
☒ 2. Reserve Bank of India  
☒ 3. HDFC Bank  
☒ 4. Life Insurance Corporation

Question Type : MCQ  
Question ID : 630680722650  
Option 1 ID : 6306802831864  
Option 2 ID : 6306802831865  
Option 3 ID : 6306802831867  
Option 4 ID : 6306802831866  
Status : Answered  
Chosen Option : 4

Q.9 Identify the tributary of the Brahmaputra River from the following.

- Ans ☒ 1. Barakar  
☒ 2. Kali Ganga  
☒ 3. Burhi Dihing  
☒ 4. Hindan

Question Type : MCQ  
Question ID : 630680510965  
Option 1 ID : 6306801996990  
Option 2 ID : 6306801996992  
Option 3 ID : 6306801996993  
Option 4 ID : 6306801996991  
Status : Answered  
Chosen Option : 3

Q.10 Jallianwala Bagh is located in which city?

- Ans ☒ 1. Amritsar  
☒ 2. Chandigarh  
☒ 3. Ludhiana  
☒ 4. Ambala

Question Type : MCQ  
Question ID : 630680362752  
Option 1 ID : 6306801412762  
Option 2 ID : 6306801412763  
Option 3 ID : 6306801412761  
Option 4 ID : 6306801412764  
Status : Answered  
Chosen Option : 1

Q.11 Children's Day in India is celebrated to commemorate the birth anniversary of \_\_\_\_\_.

- Ans ☒ 1. Pandit Jawaharlal Nehru  
☒ 2. Dr. Sarvepalli Radhakrishnan  
☒ 3. Dr. APJ. Abdul Kalam  
☒ 4. Dr. BR Ambedkar

Question Type : MCQ  
Question ID : 630680157880  
Option 1 ID : 630680611048  
Option 2 ID : 630680611049  
Option 3 ID : 630680611050  
Option 4 ID : 630680611051  
Status : Answered  
Chosen Option : 1

Q.12 Which Article of the Constitution of India describes a key feature of 'Universal Adult Franchise' that grants the right to vote to citizens, above the age of 18 years in India?

- Ans ☒ 1. Article 326  
☒ 2. Article 352  
☒ 3. Article 367  
☒ 4. Article 315

Question Type : MCQ  
Question ID : 630680406104  
Option 1 ID : 6306801583525  
Option 2 ID : 6306801583526  
Option 3 ID : 6306801583527  
Option 4 ID : 6306801583524  
Status : Answered  
Chosen Option : 2

Q.13 The Hugli industrial region is located in which state?

- Ans ☒ 1. Gujarat  
☒ 2. Telangana  
☒ 3. Karnataka  
☒ 4. West Bengal

Question Type : MCQ  
Question ID : 630680484468  
Option 1 ID : 6306801892193  
Option 2 ID : 6306801892192  
Option 3 ID : 6306801892190  
Option 4 ID : 6306801892191  
Status : Answered  
Chosen Option : 4

Q.14 Who among the following social reformers ruled out the practice of Sati on the basis of Hindu religious texts?

- Ans ☒ 1. Ishwar Chandra Vidyasagar  
☒ 2. Raja Ram Mohan Roy  
☒ 3. Swami Vivekanand  
☒ 4. Jyotiba Phule

Question Type : MCQ  
Question ID : 630680146017  
Option 1 ID : 630680564966  
Option 2 ID : 630680564968  
Option 3 ID : 630680564969  
Option 4 ID : 630680564967  
Status : Answered  
Chosen Option : 2

Q.15 Both, Rajesh Prasanna and Rishabh Prasanna are associated with which musical instrument?

- Ans ☒ 1. Flute  
☒ 2. Piano  
☒ 3. Guitar  
☒ 4. Mandolin

Question Type : MCQ  
Question ID : 630680482973  
Option 1 ID : 6306801886323  
Option 2 ID : 6306801886324  
Option 3 ID : 6306801886322  
Option 4 ID : 6306801886325  
Status : Answered  
Chosen Option : 1

Q.16 Which of the following was the mascot of the 37<sup>th</sup> National Games?

- Ans ☒ 1. Savaj  
☒ 2. Moga  
☒ 3. Ammu  
☒ 4. Chhaua

Question Type : MCQ  
Question ID : 630680799018  
Option 1 ID : 6306803130875  
Option 2 ID : 6306803130874  
Option 3 ID : 6306803130876  
Option 4 ID : 6306803130877  
Status : Answered  
Chosen Option : 2

Q.17 How many covalent bonds are present between the constituent atoms in the molecules of Butane and Hexane, respectively?

- Ans
- ☐ 1. 14 and 20
  - ☐ 2. 10 and 16
  - ☐ 3. 11 and 19
  - ☒ 4. 13 and 19

Question Type : MCQ  
Question ID : 630680426402  
Option 1 ID : 6306801663697  
Option 2 ID : 6306801663699  
Option 3 ID : 6306801663700  
Option 4 ID : 6306801663698  
Status : Not Answered  
Chosen Option : --

Q.18 Which among the following dynasties originated from the Yueh-chih tribe of China?

- Ans
- ☐ 1. Satavahanas
  - ☐ 2. Parthians
  - ☐ 3. Guptas
  - ☒ 4. Kushanas

Question Type : MCQ  
Question ID : 630680114109  
Option 1 ID : 630680441840  
Option 2 ID : 630680441841  
Option 3 ID : 630680441838  
Option 4 ID : 630680441839  
Status : Answered  
Chosen Option : 4

Q.19 Vinod Kevin Bachan has been selected for the Ustad Bismillah Khan Yuva Puraskar 2021, for his contribution to which Indian dance form?

- Ans
- ☒ 1. Odissi
  - ☐ 2. Sattriya
  - ☐ 3. Kathak
  - ☐ 4. Chhau

Question Type : MCQ  
Question ID : 630680215984  
Option 1 ID : 630680837914  
Option 2 ID : 630680837912  
Option 3 ID : 630680837911  
Option 4 ID : 630680837913  
Status : Answered  
Chosen Option : 2

Q.20 The First Battle of Panipat (1526) marked the beginning of:

- Ans
- ☐ 1. Sultanat's rule in India
  - ☐ 2. French East India Company's rule in India
  - ☐ 3. British East India company's rule in India
  - ☒ 4. Mughal's Rule in India

Question Type : MCQ  
Question ID : 630680682795  
Option 1 ID : 6306802673925  
Option 2 ID : 6306802673926  
Option 3 ID : 6306802673924  
Option 4 ID : 6306802673923  
Status : Answered  
Chosen Option : 4

Q.21 Which of the following classical dance styles manifests the element of sky?

Ans ☒ 1. Kathakali

☐ 2. Manipuri

☐ 3. Kuchipudi

☐ 4. Kathak

Question Type : MCQ

Question ID : 630680403228

Option 1 ID : 6306801572409

Option 2 ID : 6306801572412

Option 3 ID : 6306801572411

Option 4 ID : 6306801572410

Status : Answered

Chosen Option : 1

Q.22 How many fundamental duties were added by the 42<sup>nd</sup> Constitutional Amendment Act 1976?

Ans ☐ 1. Thirteen

☒ 2. Ten

☐ 3. Fifty teen

☐ 4. Eleven

Question Type : MCQ

Question ID : 630680275848

Option 1 ID : 6306801071905

Option 2 ID : 6306801071903

Option 3 ID : 6306801071906

Option 4 ID : 6306801071904

Status : Answered

Chosen Option : 2

Q.23 The novel 'Pinjar' that was later converted into a motion picture was written by:

Ans ☒ 1. Amrita Pritam

☐ 2. Dharamveer Bharati

☐ 3. Krishna Sobti

☐ 4. Ismat Chughtai

Question Type : MCQ

Question ID : 630680512094

Option 1 ID : 6306802001346

Option 2 ID : 6306802001348

Option 3 ID : 6306802001349

Option 4 ID : 6306802001347

Status : Answered

Chosen Option : 1

Q.24 Chili peppers produce a burning sensation in any tissue with which they come into contact. What is the compound responsible for this?

Ans ☐ 1. Formic acid

☐ 2. Lycopene

☐ 3. Acetic acid

☒ 4. Capsaicin

Question Type : MCQ

Question ID : 630680270026

Option 1 ID : 6306801049358

Option 2 ID : 6306801049357

Option 3 ID : 6306801049355

Option 4 ID : 6306801049356

Status : Answered

Chosen Option : 4

Q.25 Which of the following amendments, made in September 2023, is known as 'Nari Shakti Vandan Adhiniyam'?

- Ans
- ☒ 1. 104<sup>th</sup>
  - ☒ 2. 105<sup>th</sup>
  - ☒ 3. 128<sup>th</sup>
  - ☒ 4. 106<sup>th</sup>

Question Type : MCQ  
Question ID : 630680798958  
Option 1 ID : 6306803130630  
Option 2 ID : 6306803130631  
Option 3 ID : 6306803130633  
Option 4 ID : 6306803130632  
Status : Answered  
Chosen Option : 1

Section : English Language and Comprehension

Q.1 Select the INCORRECTLY spelt word.

- Ans
- ☒ 1. Comparison
  - ☒ 2. Naviggetion
  - ☒ 3. Strengthen
  - ☒ 4. Cleansing

Question Type : MCQ  
Question ID : 630680477168  
Option 1 ID : 6306801863844  
Option 2 ID : 6306801863842  
Option 3 ID : 6306801863841  
Option 4 ID : 6306801863843  
Status : Answered  
Chosen Option : 2

Q.2 The following sentence has been split into four segments. Identify the segment that contains a grammatical error.  
  
It was an insight / and determination of the lady doctor / that people were / able to lead a normal life.

- Ans
- ☒ 1. It was an insight
  - ☒ 2. that people were
  - ☒ 3. and determination of the lady doctor
  - ☒ 4. able to lead a normal life

Question Type : MCQ  
Question ID : 630680402932  
Option 1 ID : 6306801571311  
Option 2 ID : 6306801571313  
Option 3 ID : 6306801571312  
Option 4 ID : 6306801571314  
Status : Answered  
Chosen Option : 3

Q.3 Select the most appropriate option to fill in the blanks.  
I did not \_\_\_\_\_ that he would \_\_\_\_\_ the offer.

- Ans
- ☒ 1. bate; bait
  - ☒ 2. except; accept
  - ☒ 3. expect; accept
  - ☒ 4. bait; bate

Question Type : MCQ  
Question ID : 630680517446  
Option 1 ID : 6306802022181  
Option 2 ID : 6306802022183  
Option 3 ID : 6306802022182  
Option 4 ID : 6306802022180  
Status : Answered  
Chosen Option : 3

Q.4 Select the most appropriate option to fill in the blank.  
A majority of Indians prefer to use the Internet for \_\_\_\_\_ booking and other financial services.

- Ans ☒ 1. accessing  
☐ 2. attending  
☐ 3. dispersing  
☐ 4. improving

Question Type : MCQ  
Question ID : 630680515296  
Option 1 ID : 6306802013637  
Option 2 ID : 6306802013640  
Option 3 ID : 6306802013638  
Option 4 ID : 6306802013639  
Status : Answered  
Chosen Option : 1

Q.5 Select the most appropriate ANTONYM of the underlined word in the given sentence.

Radha stepped backward to avoid the incoming traffic.

- Ans ☐ 1. Affront  
☐ 2. Beside  
☐ 3. Behind  
☒ 4. Forward

Question Type : MCQ  
Question ID : 630680540680  
Option 1 ID : 6306802113781  
Option 2 ID : 6306802113779  
Option 3 ID : 6306802113778  
Option 4 ID : 6306802113780  
Status : Answered  
Chosen Option : 4

Q.6 Select the most appropriate meaning of the given idiom.

Pull someone's leg

- Ans ☐ 1. To physically pull the legs of a person  
☐ 2. To avert a great danger  
☐ 3. To take a situation seriously or earnestly  
☒ 4. To tease or play a joke on someone

Question Type : MCQ  
Question ID : 63068064322  
Option 1 ID : 630680248274  
Option 2 ID : 630680248277  
Option 3 ID : 630680248275  
Option 4 ID : 630680248276  
Status : Answered  
Chosen Option : 4

Q.7 The following sentence has been divided into parts. One of them may contain an error.  
Select the part that contains the error from the given options. If you don't find any error, mark 'No error' as your answer.

My cousin thinks that / English is difficult / than other subjects.

- Ans ☐ 1. than other subjects  
☒ 2. English is difficult  
☐ 3. No error  
☐ 4. My cousin thinks that

Question Type : MCQ  
Question ID : 630680628136  
Option 1 ID : 6306802458593  
Option 2 ID : 6306802458592  
Option 3 ID : 6306802458594  
Option 4 ID : 6306802458591  
Status : Answered  
Chosen Option : 2

Q.8 Select the option that correctly rectifies the underlined spelling error.

Thank you for this jar of asorted cookies.

- Ans
- ☐ 1. asoted
  - ☐ 2. esorted
  - ☒ 3. assorted
  - ☐ 4. essorted

Question Type : MCQ  
Question ID : 630680545202  
Option 1 ID : 6306802131555  
Option 2 ID : 6306802131556  
Option 3 ID : 6306802131558  
Option 4 ID : 6306802131557  
Status : Answered  
Chosen Option : 3

Q.9 Select the option that expresses the given sentence in future continuous tense form  
I shall come again in the afternoon for lunch.

- Ans
- ☐ 1. I will be coming again in the afternoon for lunch.
  - ☐ 2. I will come again in the afternoon for lunch.
  - ☐ 3. I shall have come again in the afternoon for lunch
  - ☒ 4. I shall be coming again in the afternoon for lunch.

Question Type : MCQ  
Question ID : 63068082885  
Option 1 ID : 630680321407  
Option 2 ID : 630680321404  
Option 3 ID : 630680321406  
Option 4 ID : 630680321405  
Status : Answered  
Chosen Option : 4

Q.10 Select the most appropriate option to fill in the blank.  
Only when the floods get \_\_\_\_\_ will world governments begin to act.

- Ans
- ☐ 1. frequently
  - ☐ 2. lucky
  - ☐ 3. gullible
  - ☒ 4. worse

Question Type : MCQ  
Question ID : 630680515222  
Option 1 ID : 6306802013356  
Option 2 ID : 6306802013353  
Option 3 ID : 6306802013354  
Option 4 ID : 6306802013355  
Status : Answered  
Chosen Option : 4

Q.11 Select the most appropriate ANTONYM of the given word.

Attract

- Ans
- ☐ 1. Recur
  - ☒ 2. Repel
  - ☐ 3. Rear
  - ☐ 4. React

Question Type : MCQ  
Question ID : 630680438810  
Option 1 ID : 6306801713053  
Option 2 ID : 6306801713055  
Option 3 ID : 6306801713054  
Option 4 ID : 6306801713052  
Status : Answered  
Chosen Option : 2

Q.12 Select the most appropriate option to fill in the blank.

Please pass \_\_\_\_\_ the salt.

- Ans ☒ 1. I  
☒ 2. me  
☒ 3. my  
☒ 4. mine

Question Type : MCQ  
Question ID : 630680490348  
Option 1 ID : 6306801915307  
Option 2 ID : 6306801915309  
Option 3 ID : 6306801915310  
Option 4 ID : 6306801915308  
Status : Answered  
Chosen Option : 2

Q.13 Select the most appropriate ANTONYM that can substitute the underlined segment in the given sentence.

Mountaineering requires a combination of physical strength, endurance, technical skill and mental fortitude.

- Ans ☒ 1. excitement  
☒ 2. enthusiasm  
☒ 3. timidity  
☒ 4. persistence

Question Type : MCQ  
Question ID : 630680549986  
Option 1 ID : 6306802150207  
Option 2 ID : 6306802150204  
Option 3 ID : 6306802150205  
Option 4 ID : 6306802150206  
Status : Answered  
Chosen Option : 4

Q.14 Select the most appropriate option to fill in the blank to complete the idiom and make the sentence meaningful.

Her company's new product launch was a real \_\_\_\_\_ squib.

- Ans ☒ 1. deaf  
☒ 2. damp  
☒ 3. dear  
☒ 4. dirty

Question Type : MCQ  
Question ID : 6306801106847  
Option 1 ID : 6306804347853  
Option 2 ID : 6306804347852  
Option 3 ID : 6306804347855  
Option 4 ID : 6306804347854  
Status : Answered  
Chosen Option : 2

Q.15 The given sentence is divided into three segments. One of them may contain a grammatical error. Select the option that has the segment with the error. If there is no error, select 'No error' as your answer.  
Meenu looks/ much better/ today.

- Ans ☒ 1. Meenu looks  
☒ 2. today.  
☒ 3. much better  
☒ 4. No error

Question Type : MCQ  
Question ID : 630680158835  
Option 1 ID : 630680614820  
Option 2 ID : 630680614822  
Option 3 ID : 630680614821  
Option 4 ID : 630680614823  
Status : Answered  
Chosen Option : 4

Q.16 Select the INCORRECTLY spelt word.

- Ans
- ☒ 1. Resort
  - ☒ 2. Scatter
  - ☒ 3. Riside
  - ☒ 4. Scarf

Question Type : MCQ  
Question ID : 630680625252  
Option 1 ID : 6306802447210  
Option 2 ID : 6306802447212  
Option 3 ID : 6306802447209  
Option 4 ID : 6306802447211  
Status : Answered  
Chosen Option : 3

Q.17 Select the most appropriate option that can substitute the underlined segment in the given sentence.

Ramesh is fond at playing guitar in his free time.

- Ans
- ☒ 1. of
  - ☒ 2. on
  - ☒ 3. in
  - ☒ 4. for

Question Type : MCQ  
Question ID : 630680419008  
Option 1 ID : 6306801634744  
Option 2 ID : 6306801634743  
Option 3 ID : 6306801634746  
Option 4 ID : 6306801634745  
Status : Answered  
Chosen Option : 1

Q.18 The following sentence has been divided into parts. One of them may contain an error. Select the part that contains the error from the given options. If you don't find any error, mark 'No error' as your answer.

I thought of this idea / just when you called / me yesterday.

- Ans
- ☒ 1. just when you called
  - ☒ 2. I thought of this idea
  - ☒ 3. No error
  - ☒ 4. me yesterday

Question Type : MCQ  
Question ID : 630680182403  
Option 1 ID : 630680706799  
Option 2 ID : 630680706798  
Option 3 ID : 630680706801  
Option 4 ID : 630680706800  
Status : Answered  
Chosen Option : 2

Q.19 Select the most appropriate ANTONYM of the highlighted word.

The man had committed a grave offence so he was granted bail.

- Ans
- ☒ 1. trivial
  - ☒ 2. dignified
  - ☒ 3. serious
  - ☒ 4. solemn

Question Type : MCQ  
Question ID : 630680499669  
Option 1 ID : 6306801952296  
Option 2 ID : 6306801952295  
Option 3 ID : 6306801952293  
Option 4 ID : 6306801952294  
Status : Answered  
Chosen Option : 3

**Q.20** Select the most appropriate option to fill in the blank.  
Fish live in aquariums and pigs live in \_\_\_\_\_.

- Ans ☒ 1. kennels  
☒ 2. sties  
☒ 3. stables  
☒ 4. dens

Question Type : MCQ  
Question ID : 630680515241  
Option 1 ID : 6306802013431  
Option 2 ID : 6306802013432  
Option 3 ID : 6306802013429  
Option 4 ID : 6306802013430  
Status : Answered  
Chosen Option : 1

**Comprehension:**

In the following passage, some words have been deleted. Read the passage carefully and select the most appropriate option to fill in each blank.  
To forgive an injury is often (1)\_\_\_\_\_ to be a sign of weakness; it is really a sign of (2)\_\_\_\_\_.  
It is easy to allow oneself to be carried away by resentment and hate into an act of (3)\_\_\_\_\_;  
but it takes a strong character to restrain those natural passions. The man who (4)\_\_\_\_\_ an  
injury proves himself to be the superior of the man who wronged him, and puts the wrong-  
doer to shame. (5)\_\_\_\_\_ may even turn a foe into a friend.

**SubQuestion No : 21**

**Q.21** Select the most appropriate option to fill in blank number 1.

- Ans ☒ 1. given  
☒ 2. granted  
☒ 3. considered  
☒ 4. allowed

Question Type : MCQ  
Question ID : 630680192318  
Option 1 ID : 630680745866  
Option 2 ID : 630680745865  
Option 3 ID : 630680745868  
Option 4 ID : 630680745867  
Status : Answered  
Chosen Option : 3

**Comprehension:**

In the following passage, some words have been deleted. Read the passage carefully and select the most appropriate option to fill in each blank.  
To forgive an injury is often (1)\_\_\_\_\_ to be a sign of weakness; it is really a sign of (2)\_\_\_\_\_.  
It is easy to allow oneself to be carried away by resentment and hate into an act of (3)\_\_\_\_\_;  
but it takes a strong character to restrain those natural passions. The man who (4)\_\_\_\_\_ an  
injury proves himself to be the superior of the man who wronged him, and puts the wrong-  
doer to shame. (5)\_\_\_\_\_ may even turn a foe into a friend.

**SubQuestion No : 22**

**Q.22** Select the most appropriate option to fill in blank number 2.

- Ans ☒ 1. strength  
☒ 2. aptitude  
☒ 3. intelligence  
☒ 4. usefulness

Question Type : MCQ  
Question ID : 630680192319  
Option 1 ID : 630680745870  
Option 2 ID : 630680745869  
Option 3 ID : 630680745872  
Option 4 ID : 630680745871  
Status : Answered  
Chosen Option : 1

**Comprehension:**

In the following passage, some words have been deleted. Read the passage carefully and select the most appropriate option to fill in each blank.  
To forgive an injury is often (1)\_\_\_\_\_ to be a sign of weakness; it is really a sign of (2)\_\_\_\_\_. It is easy to allow oneself to be carried away by resentment and hate into an act of (3)\_\_\_\_\_; but it takes a strong character to restrain those natural passions. The man who (4)\_\_\_\_\_ an injury proves himself to be the superior of the man who wronged him, and puts the wrong-doer to shame. (5)\_\_\_\_\_ may even turn a foe into a friend.

**SubQuestion No : 23**

**Q.23** Select the most appropriate option to fill in blank number 3.

- Ans ☒ 1. jurisprudence  
☒ 2. overabundance  
☒ 3. noncompliance  
☒ 4. vengeance

Question Type : MCQ  
Question ID : 630680192320  
Option 1 ID : 630680745874  
Option 2 ID : 630680745876  
Option 3 ID : 630680745875  
Option 4 ID : 630680745873  
Status : Answered  
Chosen Option : 4

**Comprehension:**

In the following passage, some words have been deleted. Read the passage carefully and select the most appropriate option to fill in each blank.  
To forgive an injury is often (1)\_\_\_\_\_ to be a sign of weakness; it is really a sign of (2)\_\_\_\_\_. It is easy to allow oneself to be carried away by resentment and hate into an act of (3)\_\_\_\_\_; but it takes a strong character to restrain those natural passions. The man who (4)\_\_\_\_\_ an injury proves himself to be the superior of the man who wronged him, and puts the wrong-doer to shame. (5)\_\_\_\_\_ may even turn a foe into a friend.

**SubQuestion No : 24**

**Q.24** Select the most appropriate option to fill in blank number 4.

- Ans ☒ 1. forgives  
☒ 2. involves  
☒ 3. contrives  
☒ 4. achieves

Question Type : MCQ  
Question ID : 630680192321  
Option 1 ID : 630680745879  
Option 2 ID : 630680745878  
Option 3 ID : 630680745880  
Option 4 ID : 630680745877  
Status : Answered  
Chosen Option : 1

**Comprehension:**

In the following passage, some words have been deleted. Read the passage carefully and select the most appropriate option to fill in each blank.  
To forgive an injury is often (1)\_\_\_\_\_ to be a sign of weakness; it is really a sign of (2)\_\_\_\_\_. It is easy to allow oneself to be carried away by resentment and hate into an act of (3)\_\_\_\_\_; but it takes a strong character to restrain those natural passions. The man who (4)\_\_\_\_\_ an injury proves himself to be the superior of the man who wronged him, and puts the wrong-doer to shame. (5)\_\_\_\_\_ may even turn a foe into a friend.

**SubQuestion No : 25**

**Q.25** Select the most appropriate option to fill in blank number 5.

- Ans ☒ 1. Boldness  
☒ 2. Fondness  
☒ 3. Forgiveness  
☒ 4. Coyness

Question Type : MCQ  
Question ID : 630680192322  
Option 1 ID : 630680745882  
Option 2 ID : 630680745883  
Option 3 ID : 630680745881  
Option 4 ID : 630680745884  
Status : Answered  
Chosen Option : 3